



# intAct BackUp-Power

Sealed maintenance-free calcium battery (Ca/Ca) | electrolyte absorbed in glass fibre mats (AGM) | wet charged

Art.No.

## BU15

Volt	12V
Capacity	15 Ah (c20)
CCR -18°C (EN)	200 A (EN)
Electrolyte	diluted sulphuric acid
Electrolyte density	1,28 +/- 0,01 Kg/l (25° C)
Size (LxWxH)	150 x 87 x 145 mm
Weight	5,5 kg
Pos. of Terminal	1
Terminal	3
Base plate	-

### Usage



## Support for the starter battery

Supplies consumers in certain types of vehicles and keeps them charged during the start-up, thus protecting the electronics. Our recommendation as a reliable alternative to the original installed back-up battery.

- » **Increased cold start performance.**
- » **Longer life expectancy. Three times more cycle resistant** than conventional starter batteries.
- » Wet charged. **Ready to use.**
- » **Sealed valve-regulated battery (VRLA)** with gas recombination.
- » **Sealed maintenance-free and leak-proof.**
- » **Electrolyte absorbed in glass fibre mat.**
- » **Lead-calcium alloy grid plates.**



Size

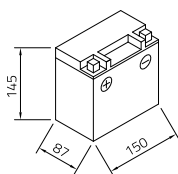

Pos. of Terminal 1

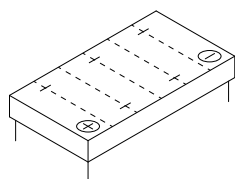

Terminal 3

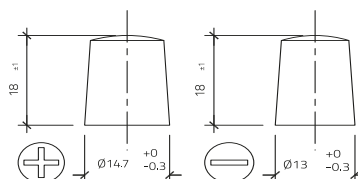

Base plate -

As of 29.08.2025